

**THE COUNCIL OF THE BOROUGH OF MILTON KEYNES
(THE COUNCIL OF THE BOROUGH OF MILTON KEYNES)
(CENTRAL MILTON KEYNES) (OFF-STREET PAY AND DISPLAY AND
PAY BY MOBILE PHONE PARKING PLACES AND DISABLED
PERSONS PARKING PLACES AND VARIOUS PERMITS) ORDER 2013)
VARIATION ORDER 2015 (No.2)**

The Council of the Borough of Milton Keynes ("the Council") in exercise of its powers under sections 1(1), 2(1) and (2), 32, 35, 44 and 53 and Part IV of Schedule 9 of the Road Traffic Regulation Act 1984 ("the Act of 1984") and of all other enabling powers, and after consultation with the chief officer of Police in accordance with Part III of Schedule 9 to the Act of 1984, hereby makes the following Order:-

**PART 1
IMPLEMENTATION AND CITATION**

1. This Order shall come into operation on the ___ day of _____ 2015 and may be cited as "The Council of the Borough of Milton Keynes (The Council of the Borough of Milton Keynes) (Central Milton Keynes) (Off-Street Pay and Display and Pay by Mobile Phone Parking Places and Disabled Persons Parking Places and Various Permits) Order 2013) Variation Order 2015 (No.2)".
2. The plans annexed to this Order identifies the lengths of road subject to this Order, provided that where there is any inconsistency between the plan and Schedules it is the wording of the Schedules which shall prevail.
3. The plans annexed to this Order is hereby annexed to the Council of the Borough of Milton Keynes (Central Milton Keynes) (Off-Street Pay and Display and Pay by Mobile Phone Parking Places and Disabled Persons Parking Places and Various Permits) Order 2013 and form part of that Order.
4. Any reference in this Order to any enactment shall be construed as a reference to that enactment as amended by any subsequent enactment.

**PART 2
VARIATIONS**

5. The Council of the Borough of Milton Keynes (Central Milton Keynes) (Off-Street Pay and Display and Pay by Mobile Phone Parking Places and Disabled Persons Parking Places and Various Permits) Order 2013 ("The Principal Order") is varied as provided by the following provisions of this Order:-
6. Articles 12 (1) and (2) is varied to the extent stated below:-

- 12 (1) The charge for a vehicle parked in an off street Pay by Mobile Phone parking space within a Pay by Mobile Phone parking place as specified in Schedules 1 and 2 to this Order shall be as specified in item 1 of Schedule 6.
- 12 (2) The charge for a vehicle parked in a long stay off street Pay by Mobile Phone parking space within a Pay by Mobile Phone parking place as specified in Schedule 3 to this Order shall be as specified in item 3 of Schedule 6
7. Articles 17 (1) and (2) is varied to the extent stated below:-
- 17 (1) The charge for a vehicle parked in an off street Pay by Mobile Phone parking space within a Pay by Mobile Phone parking place as specified in Schedules 1 and 2 to this Order shall be as specified in item 1 of Schedule 6.
- 17 (2) The charge for a vehicle parked in a long stay off street Pay by Mobile Phone parking space within a Pay by Mobile Phone parking place as specified in Schedule 3 to this Order shall be as specified in item 3 of Schedule 6
8. The following new Part 10 is inserted into the Principal Order as follows:-

PART 10

PROHIBITION OF WAITING EXCEPT WITHIN MARKED BAYS

81. No person shall except with the permission or under the direction of a police officer in uniform, a traffic warden or a Civil Enforcement Officer (CEO) cause or permit any vehicle to wait at any time outside a marked bay within the area of the car park specified in Schedule 5 of this Order.
82. Nothing in Article 81 above shall render it a contravention of this Order to cause or permit any vehicle to wait in any of the lengths of roads specified in Schedule 1 for so long as may be necessary:-
- (1) to enable goods to be loaded or unloaded from the vehicle;
 - (2) to enable a person to board or alight from the vehicle;
 - (3) If the vehicle is a goods vehicle and is delivering and/or collecting;
 - (4) when the person in control of the vehicle is required by law to stop or is obliged to stop in order to avoid an accident or is prevented from proceeding by circumstances outside his control;

- (5) for a vehicle to wait whilst any gate or other barrier at the entrance to premises to which the vehicle requires access or from which it has emerged is being opened or closed, if it is not reasonably practicable for the vehicle to wait outside otherwise than in a length of road specified in Schedules 1, 2 and 3 to this Order while such gate or other barrier is being opened or closed;
- (6) to enable the vehicle, if it cannot reasonably be used for such purpose in any other road, to be used in connection with any of the following:-
 - a) building, industrial or demolition operations;
 - b) the removal of any obstruction to traffic;
 - c) the laying, erection or repair of any sewer, main, pipe or apparatus for the supply of gas, water, electricity or any telecommunication system defined by the Telecommunications Act 1984;
 - d) use in the service of any undertaker, the Environment Agency or any public authority in pursuance of statutory powers or duties;
 - e) any wedding or funeral;
 - f) use for police, military, fire brigade or ambulance purposes;
 - g) use for the purpose of delivering or collecting postal packets as defined by section 125 of the Postal Services Act 2000;
 - h) the vehicle being specially constructed or adapted for the delivery or collection of money or valuable securities to be used for those purposes in relation to premises in the vicinity;
 - i) to carry out the removal of furniture or household effects to or from a shop, office, depository or dwelling house in the vicinity.

- 9. The title Schedule 5 of the Principal Order is revoked and replaced with the title Schedule 6.

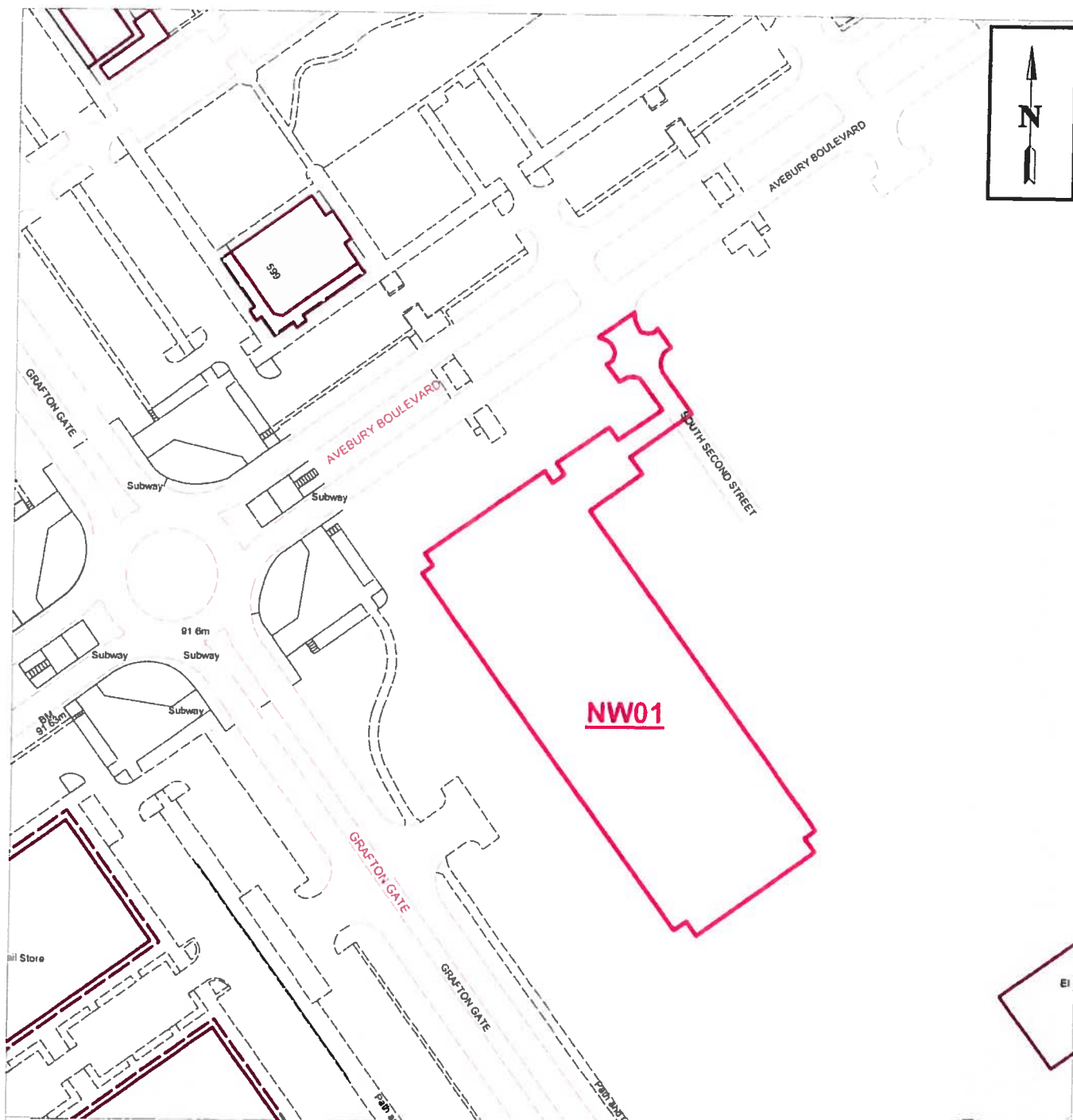

**Prohibition of waiting area
(except within marked bays)**

NW01

TRO reference

0 3,322



centimeters

Scale: 1:1,107

Map referred to in the Council of the Borough of Milton Keynes (The Council of the Borough of Milton Keynes) (Central Milton Keynes) (Off-Street Pay and Display and Pay by Mobile Phone Parking Places and Disabled Persons Parking Places and Various Permits) Order 2013) Variation Order 2015 (No.2)

Map 1

The Common Seal of the Council of the Borough of Milton Keynes was hereunto affixed in the presence of:

.....
HEAD OF LEGAL SERVICES

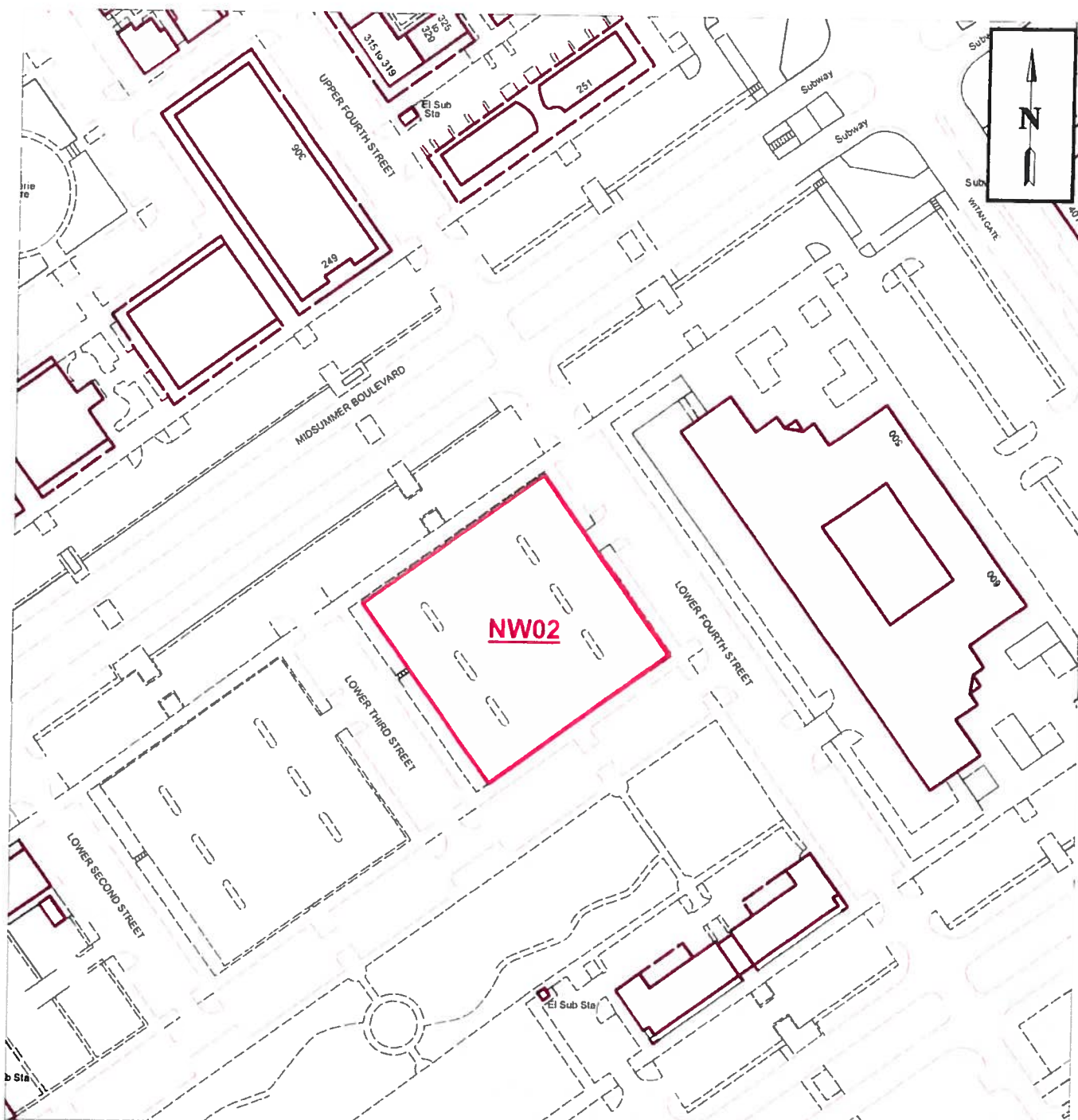

**Prohibition of waiting area
(except within marked bays)**

NW02

TRO reference

0 3,322



centimeters

Scale: 1:1,107

Map referred to in the Council of the Borough of Milton Keynes (The Council of the Borough of Milton Keynes) (Central Milton Keynes) (Off-Street Pay and Display and Pay by Mobile Phone Parking Places and Disabled Persons Parking Places and Various Permits) Order 2013) Variation Order 2015 (No.2)

Map 2

The Common Seal of the Council of the Borough of Milton Keynes was hereunto affixed in the presence of:

.....
HEAD OF LEGAL SERVICES

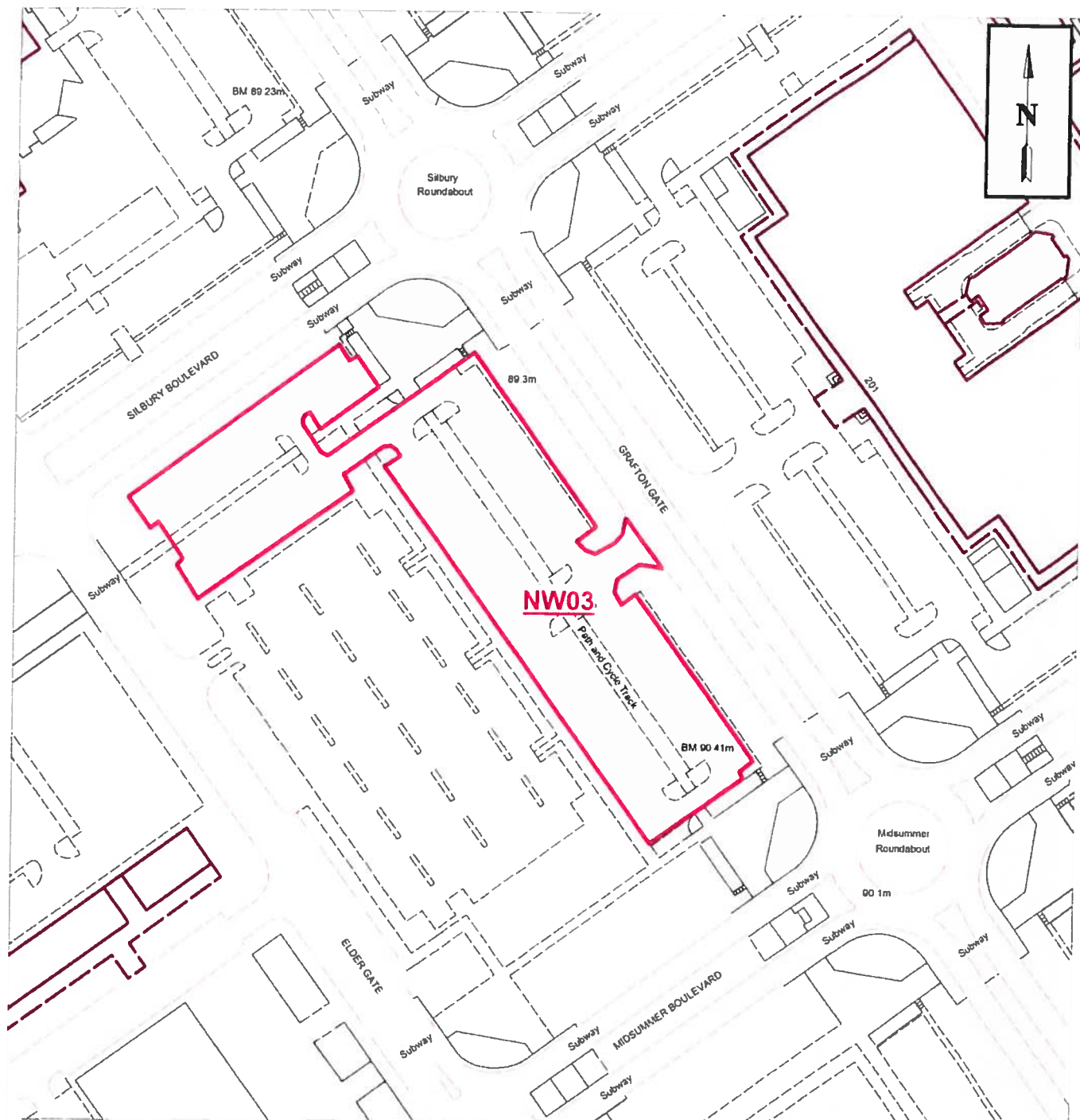

**Prohibition of waiting area
(except within marked bays)**

NW03

TRO reference

0 3,322



centimeters

Scale: 1:1,107

Map referred to in the Council of the Borough of Milton Keynes (The Council of the Borough of Milton Keynes) (Central Milton Keynes) (Off-Street Pay and Display and Pay by Mobile Phone Parking Places and Disabled Persons Parking Places and Various Permits) Order 2013) Variation Order 2015 (No.2)

Map 3

The Common Seal of the Council of the Borough of Milton Keynes was hereunto affixed in the presence of:

.....
HEAD OF LEGAL SERVICES

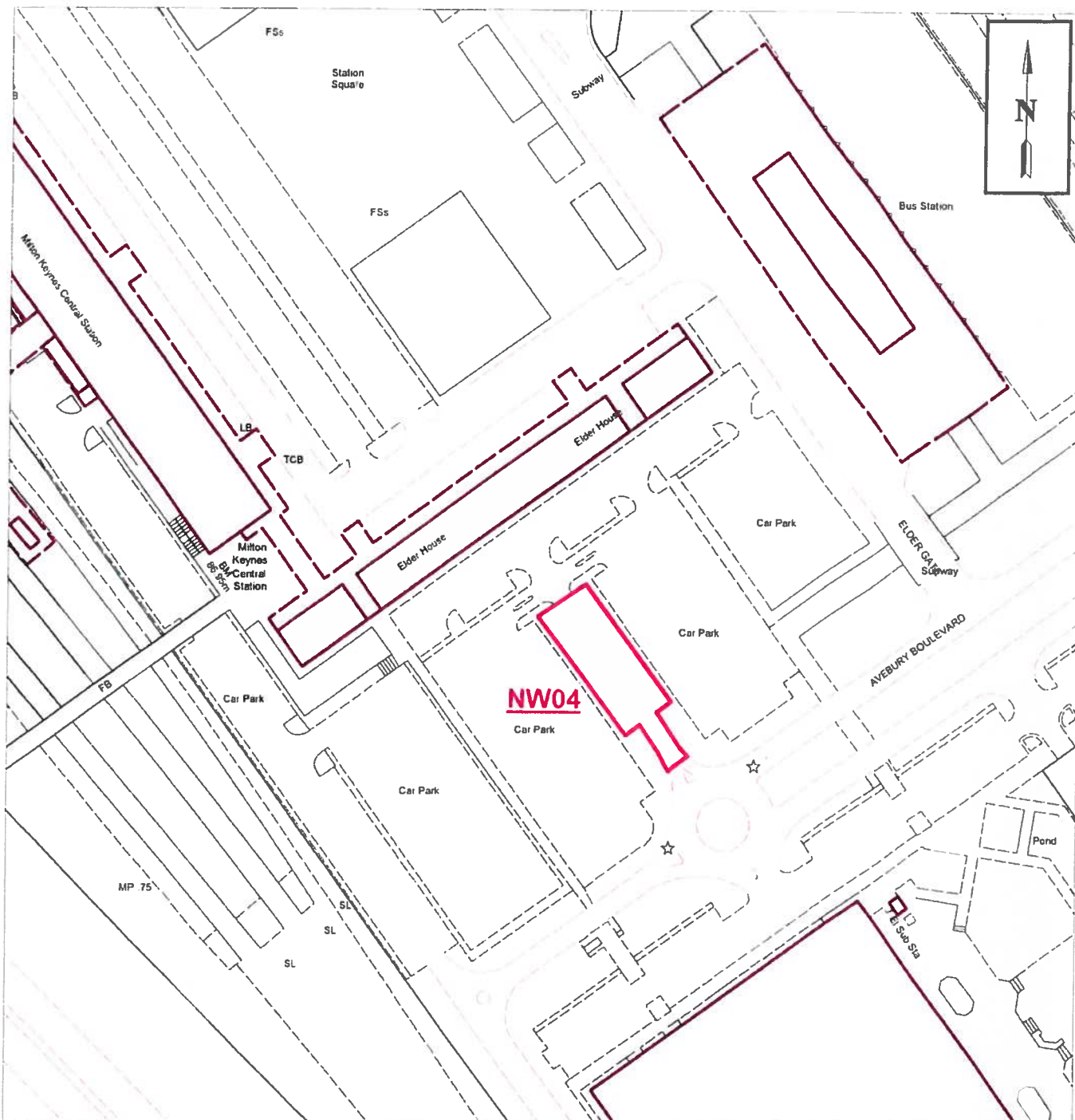

**Prohibition of waiting area
(except within marked bays)**

NW04

TRO reference

0 3,322



centimeters

Scale: 1:1,107

Map referred to in the Council of the Borough of Milton Keynes (The Council of the Borough of Milton Keynes) (Central Milton Keynes) (Off-Street Pay and Display and Pay by Mobile Phone Parking Places and Disabled Persons Parking Places and Various Permits) Order 2013) Variation Order 2015 (No.2)

Map 4

The Common Seal of the Council of the Borough of Milton Keynes was hereunto affixed in the presence of:

.....
HEAD OF LEGAL SERVICES

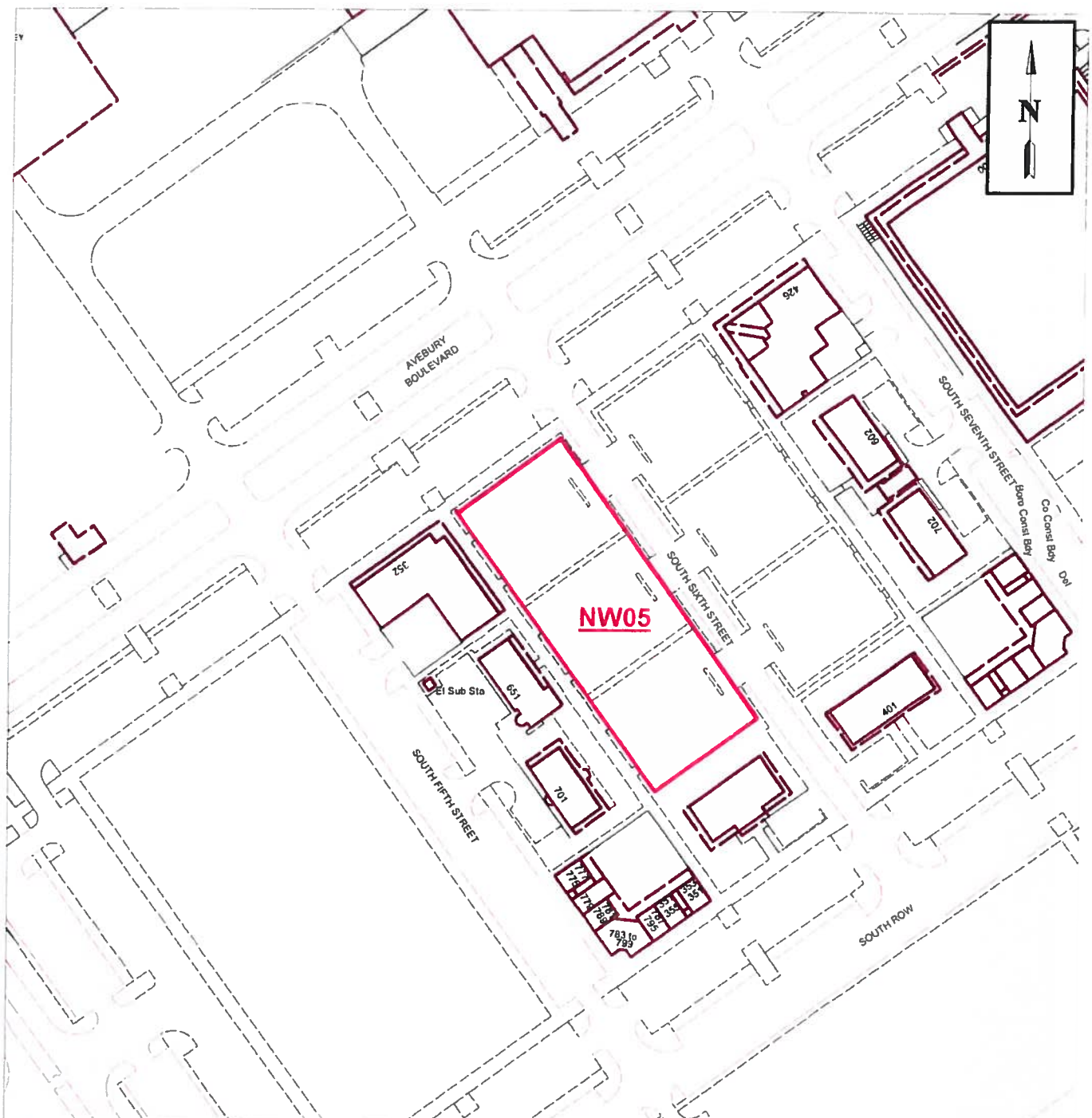

Prohibition of waiting area
(except within marked bays)

NW05

TRO reference

0 3,322



centimeters

Scale: 1:1,107

Map referred to in the Council of the Borough of Milton Keynes (The Council of the Borough of Milton Keynes) (Central Milton Keynes) (Off-Street Pay and Display and Pay by Mobile Phone Parking Places and Disabled Persons Parking Places and Various Permits) Order 2013) Variation Order 2015 (No.2)

Map 5

The Common Seal of the Council of the Borough of Milton Keynes was hereunto affixed in the presence of:

.....
HEAD OF LEGAL SERVICES

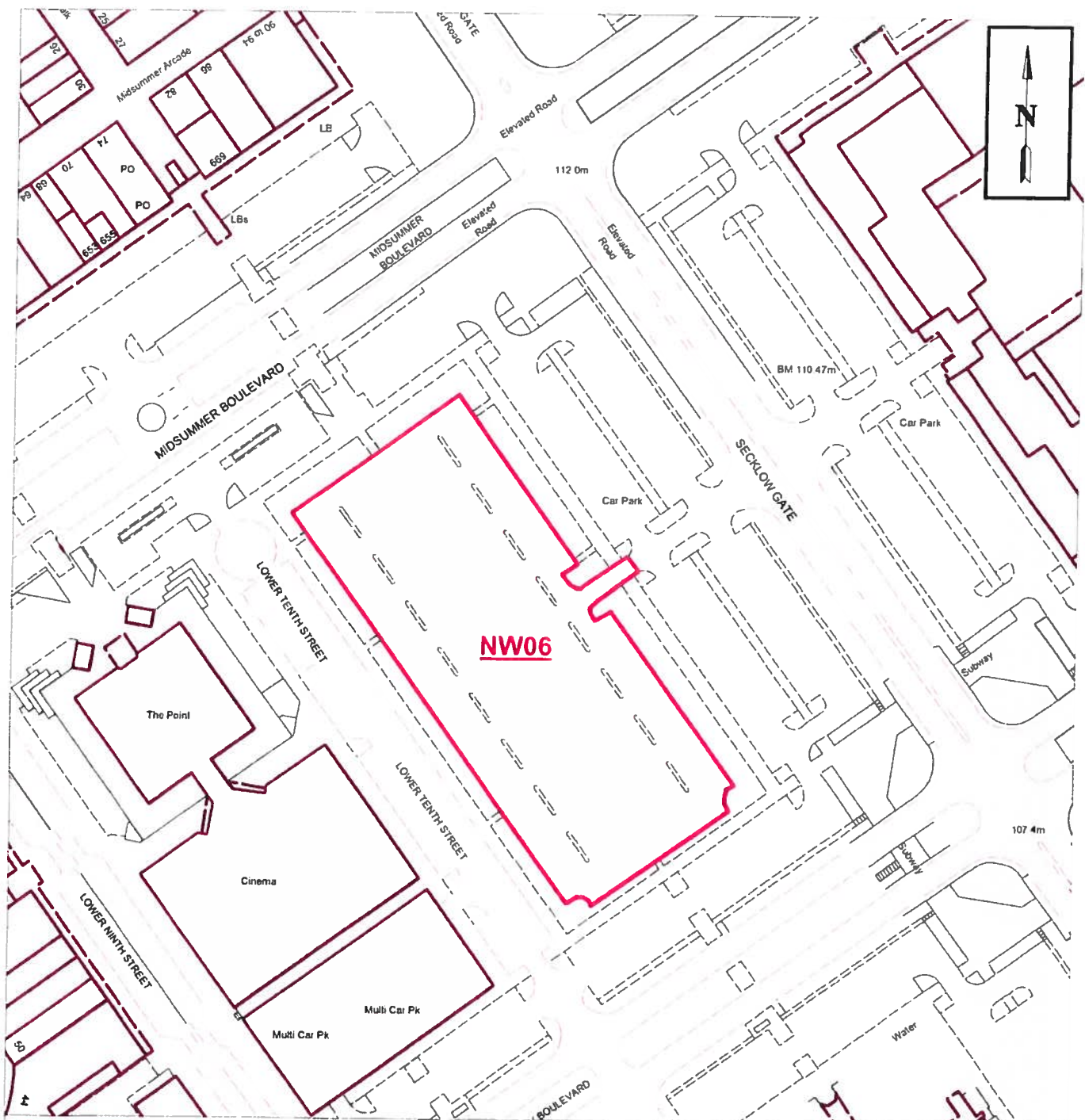

**Prohibition of waiting area
(except within marked bays)**

NW06

TRO reference

0 3,322



centimeters

Scale: 1:1,107

Map referred to in the Council of the Borough of Milton Keynes (The Council of the Borough of Milton Keynes) (Central Milton Keynes) (Off-Street Pay and Display and Pay by Mobile Phone Parking Places and Disabled Persons Parking Places and Various Permits) Order 2013) Variation Order 2015 (No.2)

Map 6

The Common Seal of the Council of the Borough of Milton Keynes was hereunto affixed in the presence of:

.....
HEAD OF LEGAL SERVICES

10. A new SCHEDULE 5 is inserted into the Principal Order:-

SCHEDULE 5

NO WAITING AT ANY TIME EXCEPT WITHIN MARKED BAYS

THE WHOLE 24 HOURS OF EVERY DAY

SOUTH SECOND STREET CAR PARK, SOUTH SECOND STREET, CENTRAL
MITLON KEYNES – SOUTH-WEST SIDE

NW01 That whole car park area from the north-east vehicular accessway from its
junction with South Second Street

LOWER FOURTH STREET CAR PARK, LOWER FOURTH STREET, CENTRAL
MITLON KEYNES – SOUTH-WEST SIDE

NW02 That whole car park area from the north-east vehicular accessway from its
junction with Lower Fourth Street

GRAFTON GATE CAR PARK, GRAFTON GATE, CENTRAL MITLON KEYNES –
SOUTH-WEST SIDE

NW03 That whole car park area from the north-east vehicular accessway from its
junction with Grafton Gate

ELDER GATE CAR PARK, THE ACCESS ROAD THAT LEADS TO ELDER HOUSE,
CENTRAL MITLON KEYNES – BOTH SIDES

NW04 That whole car park area from the south-east vehicular accessway from its
junction with Avebury Boulevard

SOUTH SIXTH STREET CAR PARK, SOUTH SIXTH STREET, CENTRAL MITLON
KEYNES – SOUTH-WEST SIDE

NW05 That whole car park area from the north-east vehicular accessway from its
junction with South Sixth Street

SECKLOW GATE CAR PARK, SECKLOW GATE, CENTRAL MITLON KEYNES –
SOUTH-WEST SIDE

NW06 That whole car park area from the north-east vehicular accessway from its
junction with Secklow Gate

THE COMMON SEAL of the **COUNCIL**
OF THE BOROUGH OF MILTON
KEYNES was hereunto affixed this
day of 2015 in the presence of:-

.....
HEAD OF LEGAL SERVICES